

# MUTUAL CPH

## MANUAL

- STEEL TUBES,  $\varnothing$  24 MM
  - PLYWOOD, 450x950x12 MM
  - SILNYLON FABRIC
  - PLA FILAMENT or FLAKES
  - ALUMINIUM
  - HIGH CARBON STEEL
  - BIKE WHEEL & TIRE, 16" x 4 CM
- CARGO BELTS
  - INDUSTRIAL RUBBER STRAPS
  - COMPACT BIKE LIGHTS
  - BATTERIES
  - E-BIKE MOTOR
  - ACCELERATION SENSOR
- TUBE BENDING MACHINE
  - WELDING MACHINE
  - CNC MILL & FLAT END MILL
  - 3D PRINTER
  - LASERCUTTER & PLOTTER
  - SCREWS & NUTS
  - SCREW DRIVER & BITS
- ULTRA SONIC WELDING MACHINE
  - or SEWING MACHINE
  - POWDER COATER
  - or SPRAY PAINT GUN

01

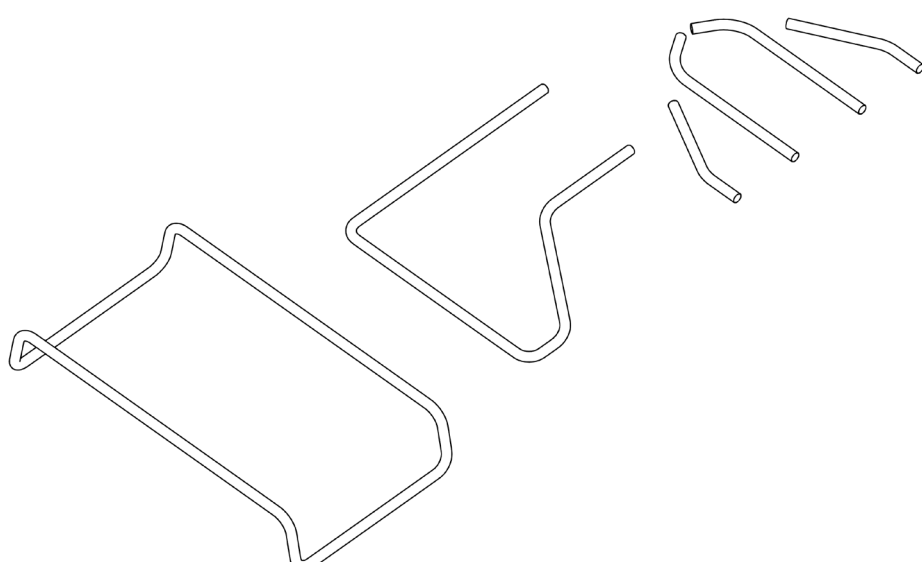

02

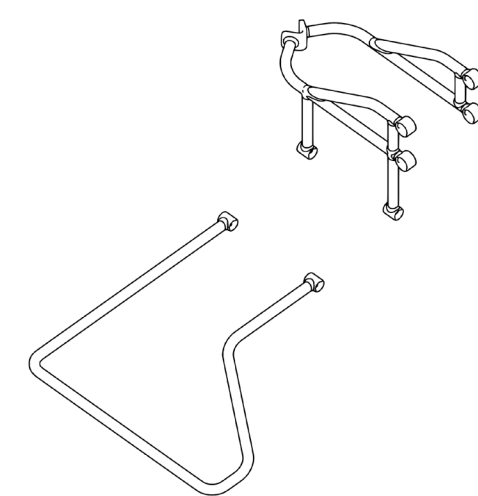

CUT & BEND TUBES

05

04

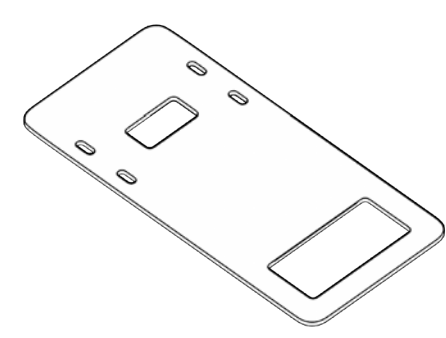

CNC MILL BASEPLATE

+

03

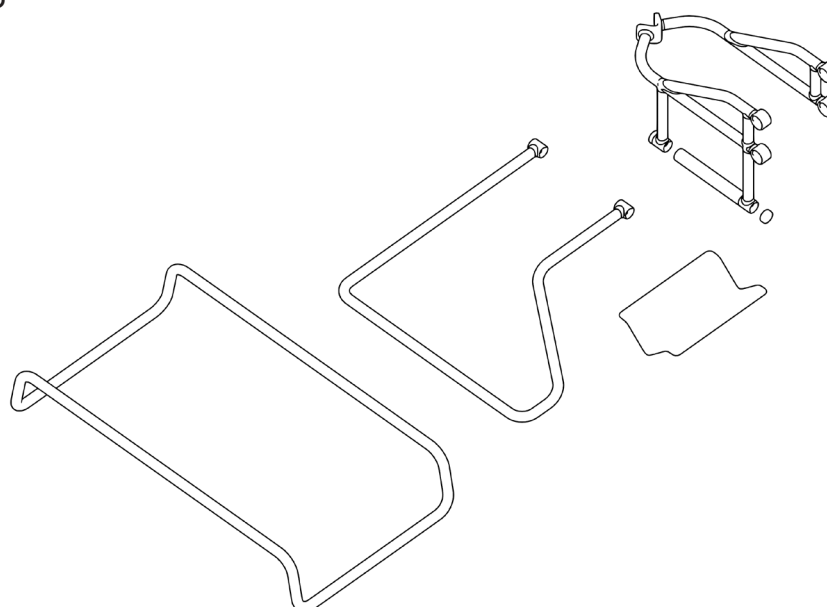

WELD TUBES

+

06

COAT OR PAINT TUBES

3D PRINT PARTS

LASERCUT FABRIC & PLOT DECALS

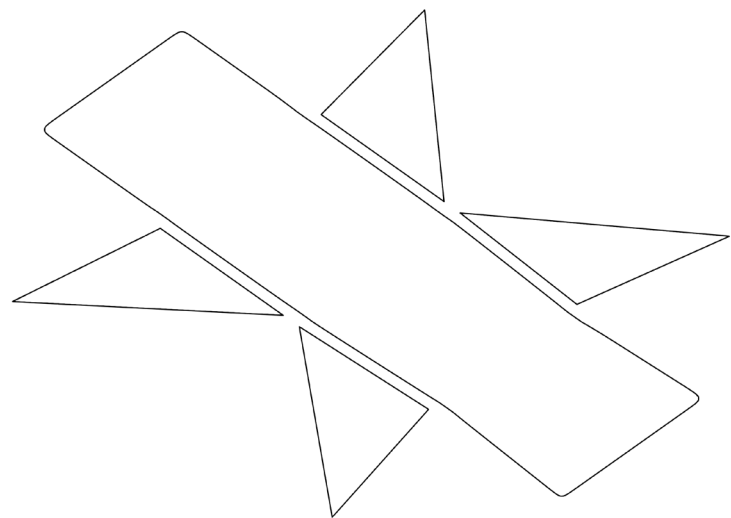
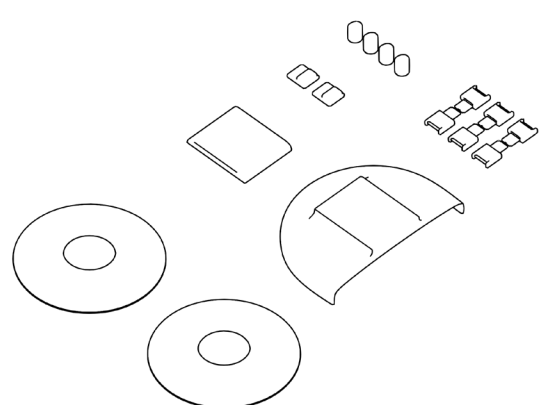

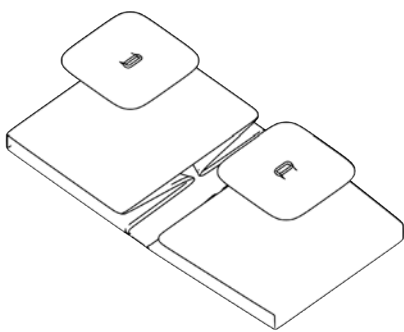

ULTRASONIC WELD OR SEW SEAMS

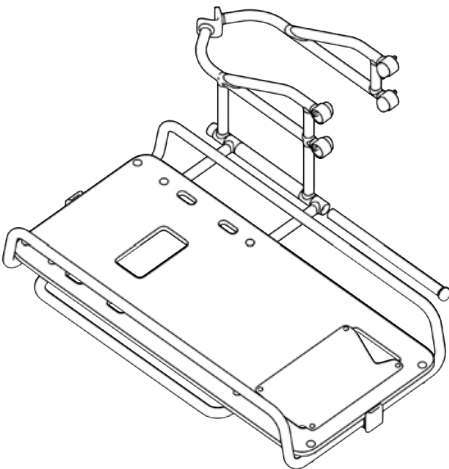

MOUNT BRACKET & BEARINGS

SCAN TO SEE MODEL IN AR

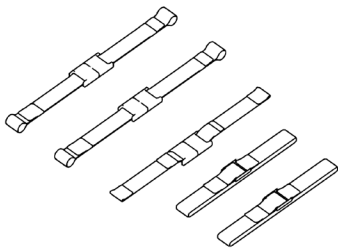

ATTACH BELTS & BUCKLES

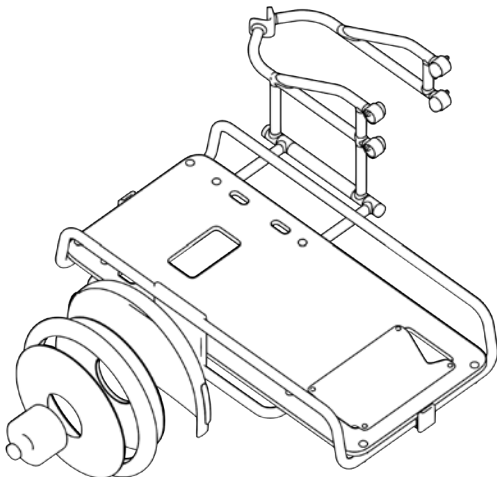

ASSAMBLE & ATTACH WHEEL

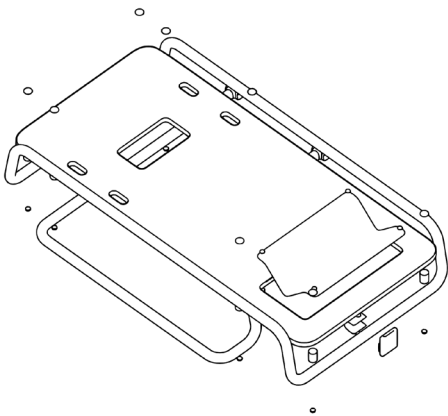

MOUNT BOARD TO FRAME

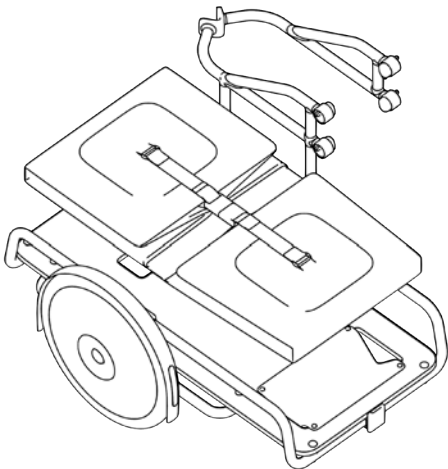

ATTACH BASKET

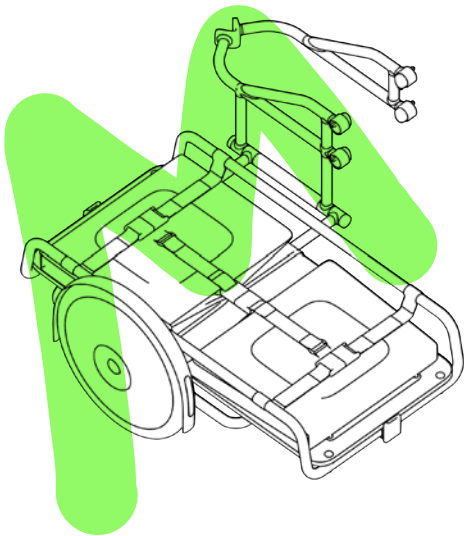

FOR ACCESS TO VECTOR AND 3D FILES, FEEDBACK AND FURTHER INFORMATION, PLEASE CONTACT:

**TILLMANN.TOBEN@EDU.FH-JOANNEUM.AT**

THIS CONCEPT IS THE OUTCOME OF A COLLABORATIVE IDEATION PROCESS CONDUCTED BY **MUTUAL** IN COPENHAGEN AND IS RELEASED UNDER A CREATIVE COMMONS **BY-NC-SA** LICENSE.  
THE PROJECT CAN BE DISTRIBUTED, REMIXED, ADAPTED, AND BUILT UPON FOR **NONCOMMERCIAL USE** AS LONG AS **CREDIT** IS GIVEN TO THE CREATORS AND ADAPTATIONS HAVE THE **SAME LICENSE**.